

E1W BRASS ECONOMY GLANDS

E1W brass glands for use with SWA cables. Used in indoor and outdoor applications.

Standards:

- BS6121: Part 1: 2005. BSEN50252

Kit contents:

- Gland with Neoprene/Nylon Ring Gasket
- Locknut
- Earth Tag
- PVC Shroud

Additional Accessories available (upon request):

- Nylon Washers
- Fibre Washers
- Serrated Washers

SPECIFICATION DATA

Batt Part No.	Gland Size	Metric Thread	Min. Thread Length (mm)	Cable Diameter (mm) "B"		Armor Wire Diameter	Max Across Corners (mm)
		"C"	"D"	Min	Max	(mm)	"E"
88699	20s/16mm	M20	15	6.0	13.4	0.9	24.4
88700	20s	M20	10	9.5	15.9	0.9/125	26.6
88701	20mm	M20	10	12.5	20.9	0.9/125	33.3
88710	25mm	M25	10	17.0	26.2	1.25/1.60	40.5
88711	32mm	M32	10	22.9	33.9	1.60/2.00	51.0
88712	40mm	M40	15	26.0	40.4	1.60/2.00	61.0
-	50s	M50	15	35.0	46.7	2.00/2.50	66.5
-	50mm	M50	15	38.0	53.1	2.00/2.50	77.7
-	63s	M63	15	45.6	59.4	2.50	83.2
-	63mm	M63	15	54.6	65.9	2.50	88.7
-	75s	M75	15	57.0	72.1	2.50	101.6
-	75mm	M75	15	60.4	78.5	2.50/3.15	111.1
-	90mm	M90	15	69.2	90.4	3.15	128.6

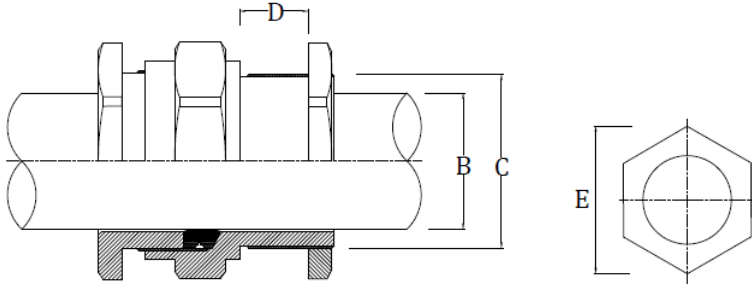

The information in this datasheet is for guidance only and subject to change without liability. Images provided are representations; actual cable dimensions may vary due to manufacturing tolerances.

www.battcables.com | 01322 441165

©2024 Batt Cables Limited

