

BW LSF BRASS ECONOMY GLANDS

BW brass glands for use with SWA LSZH cables. Used in indoor applications (not requiring weather-proof feature of an inner or outer seal).

Standards:

- BS6121: Part 1: 2005

Kit contents:

- Gland
- Locknut
- Earth Tag
- LSF Shroud (*PVC Shroud version also available*)

Additional Accessories available (on request):

- Nylon Washer
- Fibre Washer
- Serrated Washer

SPECIFICATION DATA

Batt Part No.	Gland Size	Metric Thread	Min. Thread Length (mm)	Cable Diameter (mm)		Armour Wire Diameter	Max Across Corners (mm)
		"C"	"D"	"A" Max	"B" Max	(mm)	"E"
88102	20s	M20	10	11.6	16.1	0.9/1.25	24.4
88585	20mm	M20	10	13.9	21.1	0.9/1.25	30.0
88588	25mm	M25	10	19.9	27.4	1.25/1.60	36.0
88590	32mm	M32	10	26.2	34.4	1.60/2.0	44.5
88897	40mm	M40	15	32.1	42.4	1.60/2.0	56.3
88920	50s	M50	15	38.1	50.1	2.00/2.50	63.4
88898	50mm	M50	15	44.0	55.7	2.00/2.50	72.1
88899	63s	M63	15	50.0	62.4	2.50	83.0
88921	63mm	M63	15	55.9	68.2	2.50	88.7
-	75s	M75	15	61.9	76.8	2.50	99.8
88900	75mm	M75	15	67.9	82.9	2.50/3.15	105.3

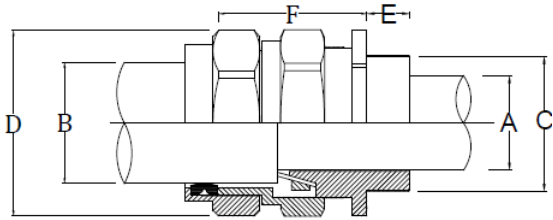

The information in this datasheet is for guidance only and subject to change without liability. Images provided are representations; actual cable dimensions may vary due to manufacturing tolerances.

www.battcables.com | 01322 441165

©2024 Batt Cables Limited

